



PROJECT FIELD INSPECTION REPORT

Use this form to:

- 1) Record pre-job inspection information for the purpose of recommending the correct water repellent(s) and application procedure(s)
- 2) Report a post-job inspection of a property for the purpose of confirming desired results, or recommending supplemental treatment if required.
- 3) Report post-job inspection results for the purpose of warranty consideration. In order to obtain an extended warranty, a post-job inspection must be submitted in conjunction with the mandatory Pre-Inspection information sections (*), a Contractor Verification Form and supporting materials receipts.

* PROJECT NAME & LOCATION	
General Description of Project	
General Contractor Name & Contact Information	
Coatings Contractor Name & Contact Information	
OKON Supplier & Contact Information	

Pre-Job Inspection

Items to be examined and reported prior to water repellent application
 * Indicates sections required on this report, for warranty consideration.

1. * BUILDING MATERIALS (check all that apply):				
Concrete, cast or poured:	Poured in place _____	Tilt-up _____	Precast Panels _____	Other (specify) _____
CMU (see reference guild)	Smooth _____	Split _____	Fluted _____	Other (specify) _____
Other material	Brick _____	Stucco _____	EIFS _____	Natural Stone _____
List other building materials not identified above				

2. * MORTAR JOINTS (see reference guild):				
Raked _____	Curved _____	Flush _____	Squeezed _____	Bead _____

3. * EFFLORESCENCE DEPOSITS PRESENT?		Yes _____	No _____
If Yes, Was cleaning recommended?		Yes _____	No _____

4. PROPERTY AND BUILDING DRAINAGE			
Landscape slope from bldg _____	Gutters Installed _____	Downspouts Installed _____	Other Notes:

5. * PARAPET WALL, CAPPED & SEALED? (see reference guild):		
Does the building construction included a parapet wall?	Yes _____	No _____
If yes, is the wall capped, and the backside sealed?	Yes _____	No _____

6. PARAPET WALL, OPTIONAL INFORMATION			
Wall Type:	Concrete _____	Stucco _____	Other (specify):
Cap Type:	Metal _____	Elastomeric _____	Other (specify):
Backside Seal:	Tar _____	Roofpaper _____	Other (specify):

7. CAULKING:			
Windows & Doors _____	Dissimilar Substrate Joints _____	Control/Expansion Joints _____	Other areas, recommendations:

8. STRUCTURAL CRACKING OBSERVED?	Yes _____	No _____
If Yes, location & recommendation		

9. * WATER REPELLENT PRODUCT RECOMMENDATION, ESTIMATE OF REQUIRED MATERIALS		
RILEM Test Results (Conduct a minimum of one 3-minute test per building directional facing. Report substrate type and water loss in ml during 3-minute test)	North _____	
	East _____	
	South _____	
	West _____	
Is Building Clean, Dry & Ready for Sealing?	Yes _____	No _____
Water Repellent Product(s) to be Used		
Technical Data Bulletin, or other specified application procedures and coverage guidelines provided?	Yes _____	No _____
Approx Surface Area to be Sealed		

*** For warranty consideration, complete the required sections, and submit with at least two photos showing building (wide shot) and substrate (close-up). Following application, also complete the Post-Job Inspection (below) and submit with other required documentation (Contractor Verification Form and materials receipts)**

Post-Job Inspection

Documentation required after water repellent application:

1. *RILEM TEST RESULTS (ONE 3-MINUTE TEST PER BUILDING DIRECTIONAL FACING. REPORT WATER LOSS IN ML DURING 3-MINUTE TEST)	North _____	
	East _____	
	South _____	
	West _____	
2. *IS THE BUILDING PROPERLY SEALED	Yes _____	No _____
3. IF NO, OTHER ACTION RECOMMENDED		

*** For warranty requests, submit this report with mandatory pre-job and post-job sections completed, plus Contactor Verification Form and Materials Receipts.**

Inspected by (print name, add signature): _____

Company: _____

Date: _____

REFERENCE GUIDE

Parapet cap and backside of parapet wall must be sealed with metal or elastomeric to qualify for a warranty .

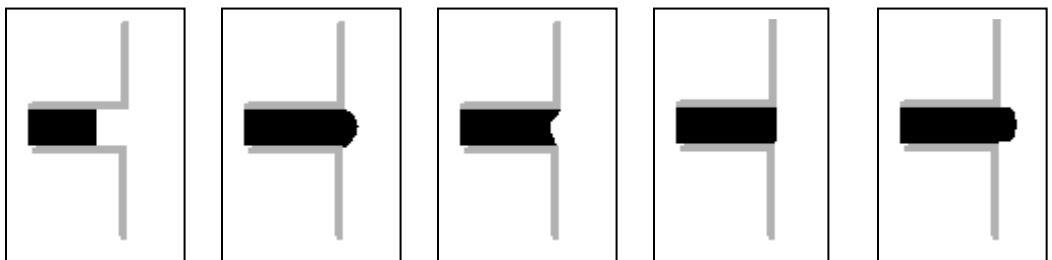
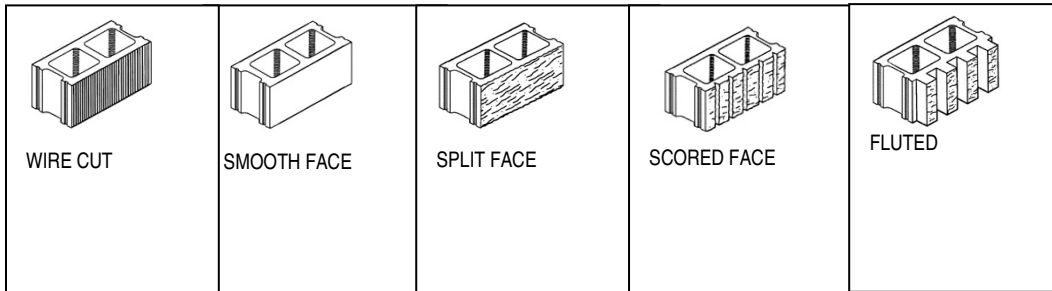
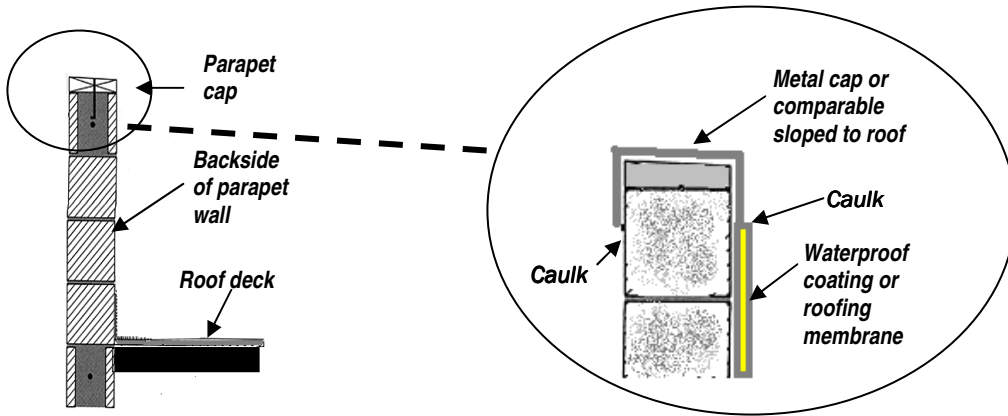

Raked joint

Squeezed

V or Curved

Flush

Bead

N:W

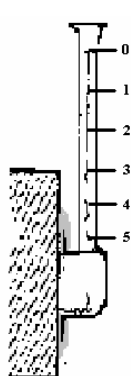

Condition	Water Loss (mL)	Rating (3 minute test)
Uncoated	5	Very porous
	2	Porous
	.5	Dense
Coated	3	Poor protection
	.5	Good protection
	0	Excellent protection

9.doc